

School Board Election
Districts

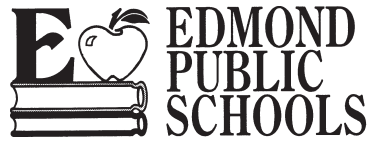

N

Miles

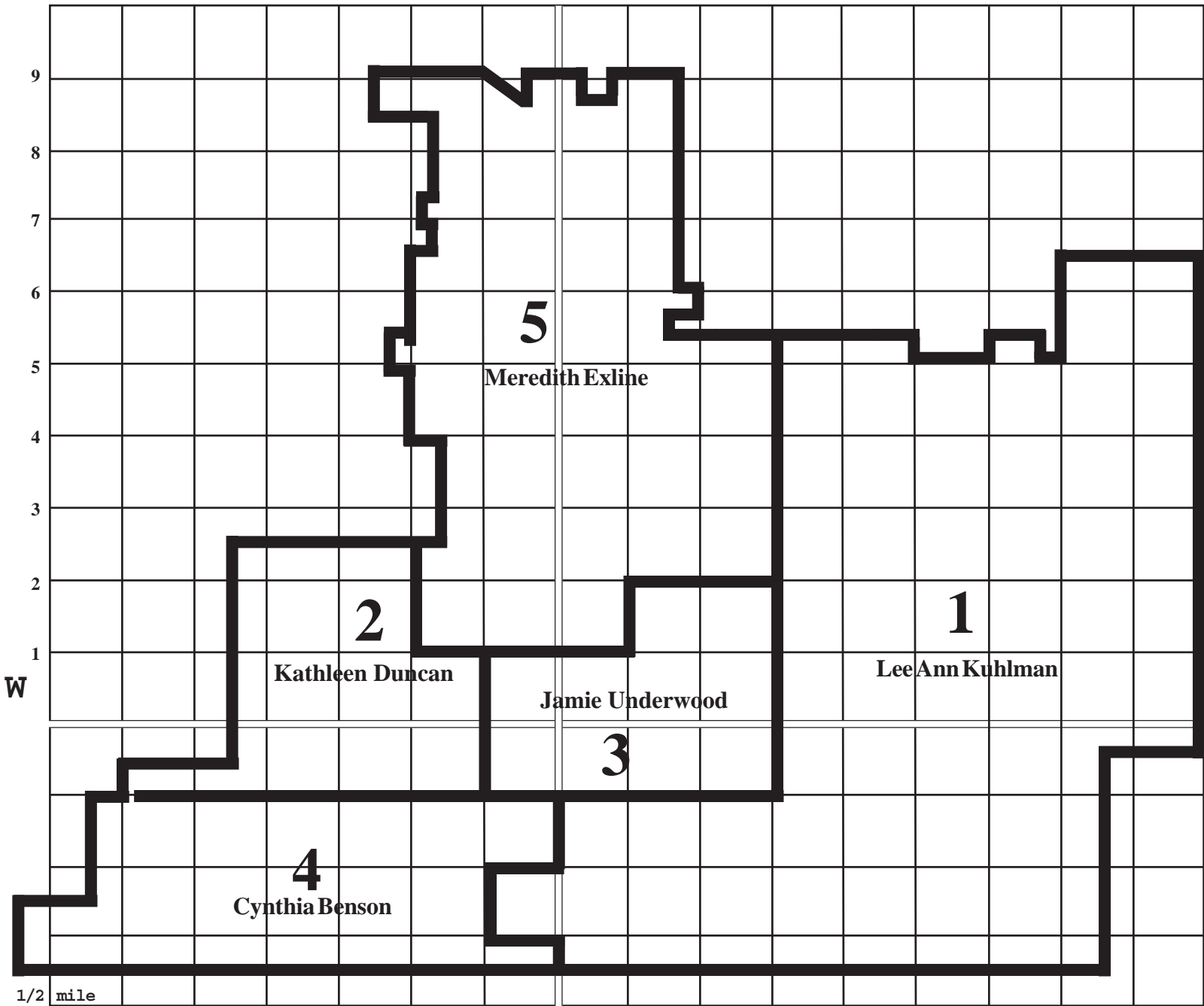

- Seward Road
- Liberty Lake Rd.
- Simpson Rd.
- Charter Oak Rd.
- Simmons Rd.
- Waterloo Rd.
(County Line
NW 248)
- Sorghum Mill Rd.
NW 234
- Coffee Creek Rd.
NW 220
- Covell
NW 206
- Danforth
NW 192
- 2nd St.
Hwy. 66
- 15th St.
NW 164
- 33rd St.
NW 150
- Memorial Rd.
- NW 122

E

S

- Meridian
- Portland
- May
- Pennsylvania
- Western
- Santa Fe
- Kelly
- Eastern
Boulevard
- Bryant
- Coltrane
- Sooner Road
- Air Depot Road
- Midwest Blvd.
- Douglas Blvd.
- Post Road
- Westminster
- Anderson

2011 SCHOOL BOARD ELECTION DISTRICTS
OKLAHOMA COUNTY
I-12
EDMOND PUBLIC SCHOOLS

APPROVED 9-6-11

ELECTION DISTRICT #1

Beginning at the intersection of 1/2 mile north of Waterloo Road on Sooner Road; south to 15th Street; west to Eastern/Boulevard; south to NW 150 (33rd Street), west to Kelly, south to Memorial Road; east to Eastern/Boulevard; south to ½ mile south of Memorial Road; east to ½ mile east of Post Road; north to ½ mile north of 15th Street; west to Anderson Road. This constitutes the western and southern boundary of the #1 election district. The area east and north of this line is included in election district #1.

ELECTION DISTRICT #2

Beginning at the intersection of 15th (NW 164) and Kelly; west to Portland; north ½ mile; east 1-1/2 miles to a point located ½ mile east of May; north 3 miles to a point located ½ mile north of Covell; east 2-1/2 miles to Santa Fe; south to Danforth, east to Kelly, south to 15th Street (NW 164) (the beginning point.)

ELECTION DISTRICT #3

Beginning at the intersection of Covell and Sooner Road; south to 15th Street; west to Kelly; north to Danforth; east to Bryant; north to Covell; east to Sooner Road (the beginning point.)

ELECTION DISTRICT #4

Beginning at intersection of 15th and Boulevard; south to 33rd (NW 150); west to Kelly; south to Memorial Road; east to Eastern/Boulevard; south to ½ mile south of Memorial Road; west to a point ½ mile west of Meridian; north 1 mile to a point located ½ mile north of Memorial Road; east one mile to a point located ½ mile east of Meridian; north to 15th (NW 164th); east on 15th to Eastern/Boulevard (the beginning point.)

ELECTION DISTRICT #5

Beginning at intersection of ¼ mile north of Waterloo on Sooner Road; south to Covell; west to Bryant; south to Danforth; west to Santa Fe; north 1-1/2 miles to a point ½ mile north of Covell. This constitutes the eastern and southern boundary of the #5 election district. The area west and north of this line is included in election district #5.